

TABLES DE CONVERSION
CONVERSION TABLES

Longueur/Length

yards = metres / 0.9144 metres = yards x 0.9144
feet = metres / 0.3048 metres = feet x 0.3048

Poids/Weight

lb = $\frac{45}{11}$ x 11 kg = $\frac{11}{11}$ x 5

Volume/Volume

1 litre = approximately 1 1/4 pints or 0.22 gallons

N.B.: Les anglophones indiquent la décimale en utilisant un point
In France, the decimal point is indicated by a comma

Mesures Internationales/Metric Measures

Longueur/Length

1 mètre (m) = 100 cm = 1.0936 yards (yds)

Surface/Area

1 cm² = 100 mm² = 0.1550 square (sq.) in
1 m² = 10000 cm² = 1.1960 sq. yds

Pression/Pressure

1 bar = 100 kPa = 14.5036 lb per in² (psi)

Mesures britanniques/Imperial Measures

Longueur/Length

1 inch = 0,0254 m
1 foot = 0,3048 m
1 yard = 0,9144 m

Surface/Area

1 sq. inch = 6,4516 cm²
1 sq. foot = 144 sq. ins = 0,0929 m²
1 sq. yard = 1296 sq. ins = 0,8361 m²

Capacité/Capacity

1 cu. inch = 16,387 cm³
1 cu. foot = 1728 cu. inches = 0,0283 m³

Pression/Pressure

1 psi = 6,895 kPa

PLAN DE SITUATION
LOCATION PLAN

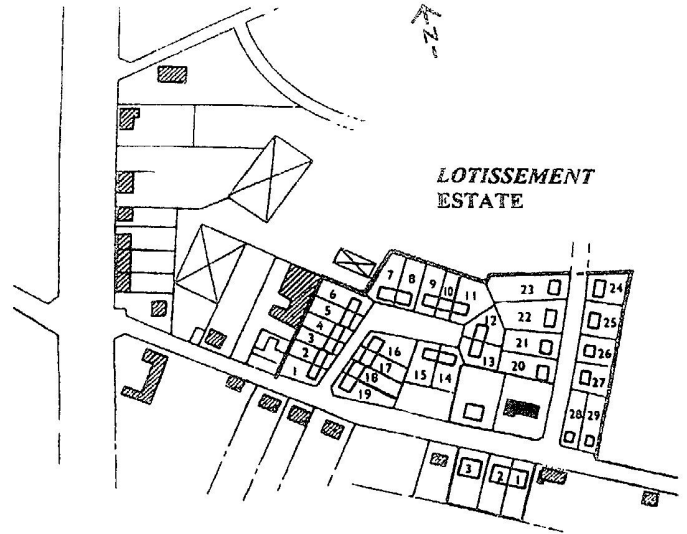

PLAN DE MASSE
BLOCK PLAN

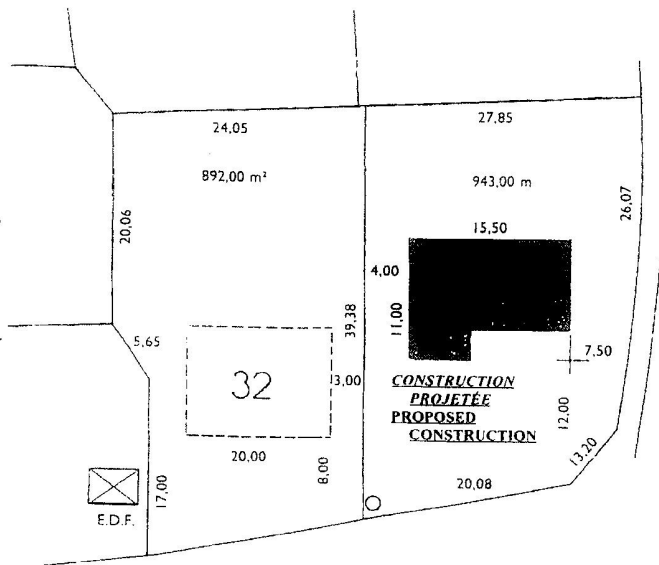

FAÇADE EST
EAST ELEVATION

